

## Parts List

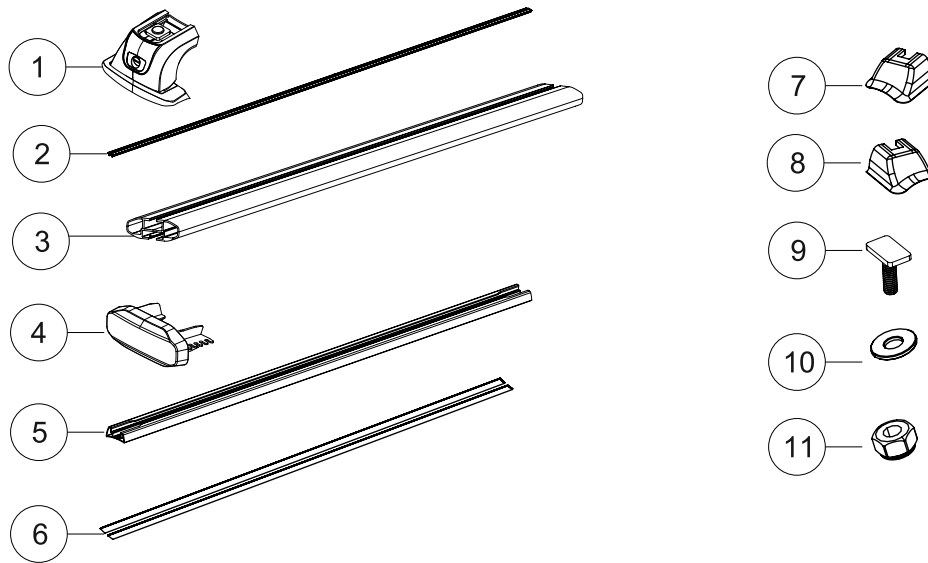

Items	Component Name	Part No.	Q'ty	Tools
	AEROKLAS UNIVERSAL ROOF RACK LEG(SET)			1.Tape Measure 2.4 Drill Bit 3.8 Drill Bit 4.Drill 5.Marking Tape 6.Marker 7.Silicone 8.Soldering Iron 9.Hex Wrench 10.Wrench
1.	ROOF RACK LEG (SET)	102000001113	1	
	AEROKLAS UNIVERSAL CROSS BAR(SET)			
2.	RUBBER STRIP (L1375)	102000000944	2	
3.	CROSS BAR (L1375)	102000000966	2	
4.	CROSS BAR ENDCAP	102060000967	4	
	AEROKLAS UNIVERSAL ROOF RAIL(SET)			
5.	TRACK(L885)	102000000947	2	
6.	FOAM CR+ADHESIVE TAPE 2 SIDE (10x885x1.3)	102090000065	4	
7.	TRACK ENDCAP LR/RF	102000000948	2	
8.	TRACK ENDCAP LF/RR	102000000949	2	
9.	T-BOLT M6x20	102060000062	14	
10.	PLAIN WASHER M6 (OD 24x2)	102040000074	14	
11.	NYLON NUT M6	102000000950	14	

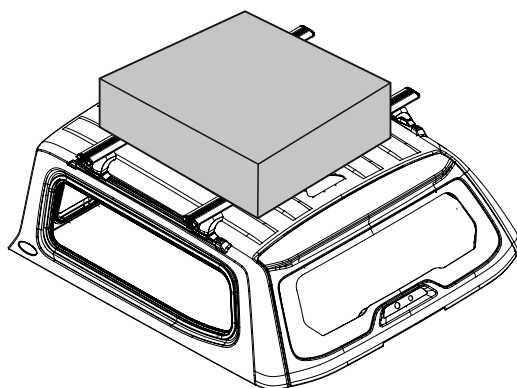

## Max load on top 100 kg

Please refer to your vehicle manufacturers handbook for maximum carrying capacity.

Always use the lower of the two figures.

Load must be evenly distributed over the entire Pioneer. Weight of roof rack accessories is to be included in cargo allowance.

### **Torque settings:**

Unless stated otherwise in these instructions, all fasteners should be set to the following torque settings - M6: 4-5Nm (3-4lbs/ft), M8: 8-10Nm (6-7.5lbs/ft) and M10: 16-18Nm (12-13lbs/ft).

### **Warning:**

- Check Part No. and/ or Kit is correct for use with your vehicle
- Do not attempt to fit the rack system to your vehicle unless you fully understand these fitting instructions. Please direct any questions regarding fitting to the dealer from where the roof racks were purchased.
- Use only non-stretch fastening ropes or straps.
- The handling characteristics of the vehicle changes when you transport a load on the roof. For safety reasons we recommend you exercise extreme care when transporting wind-resistant loads. Special consideration must be taken into account when cornering and braking.
- Although the system is tested and approved to AS1235-2000, off-road conditions can be much more rigorous. Extreme care must be taken in off road conditions.
- Roof racks must be removed when vehicle is put through an automatic car wash.

### **Recommendations:**

It is essential that all bolt connections be checked after driving a short distance when you first install your roof racks.

Bolt connections should be checked again at regular intervals (once a week is enough, depending on road conditions, usage, loads and distances travelled).

You should also check the roof racks each time they are re-fitted. Always make sure to fasten your load securely. Please also ensure that all loads are evenly distributed and that the centre of gravity is kept as low as possible and must be entirely contained within the extents of the roof racks.

### **Note for Dealers and Fitters:**

It is your responsibility to ensure these fitting instructions are given to the end user or client

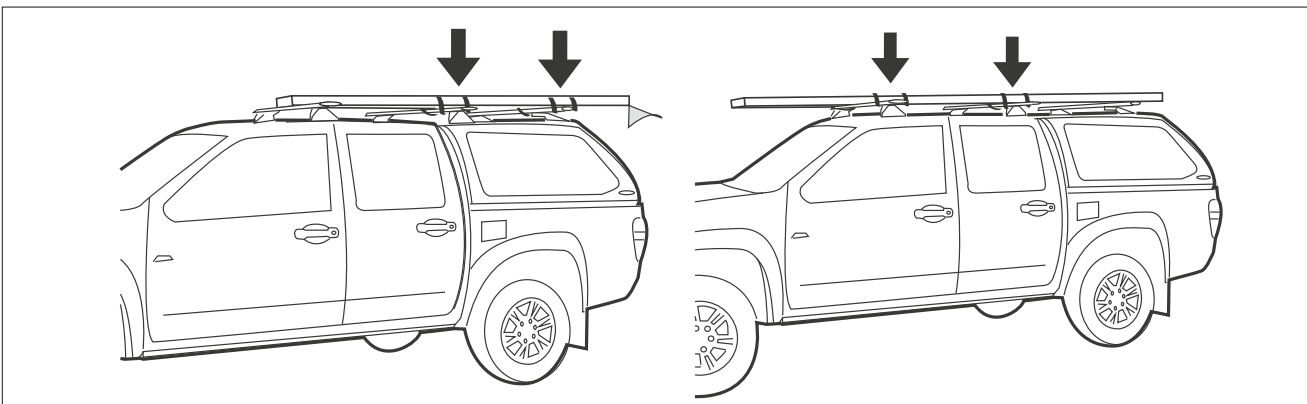
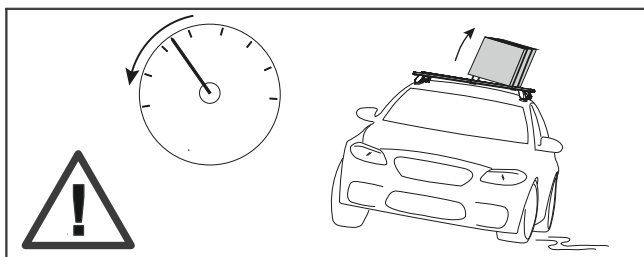
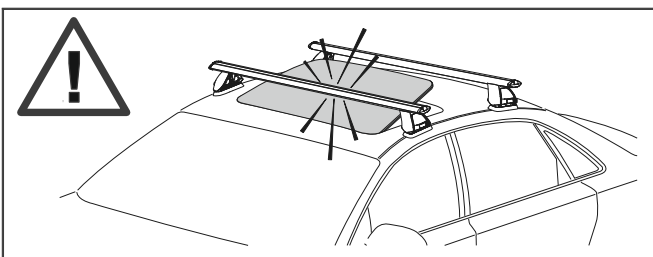
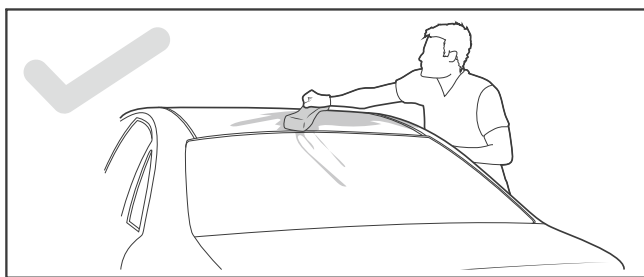
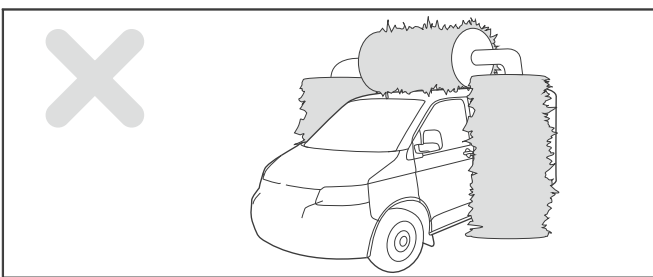
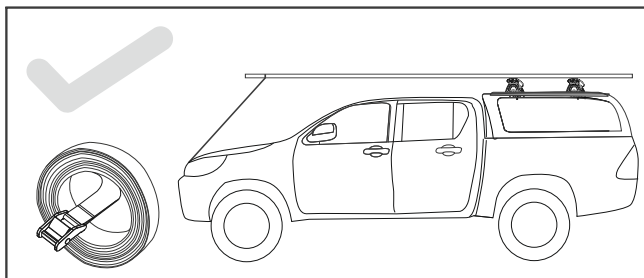
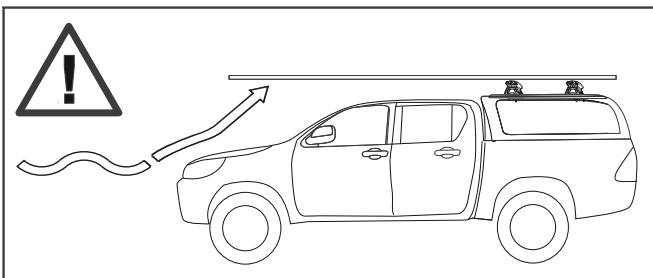



1

Place masking tape onto the canopy to adequately cover the approximate area to be drilled protecting the polished canopy finish from being scratched during installation.

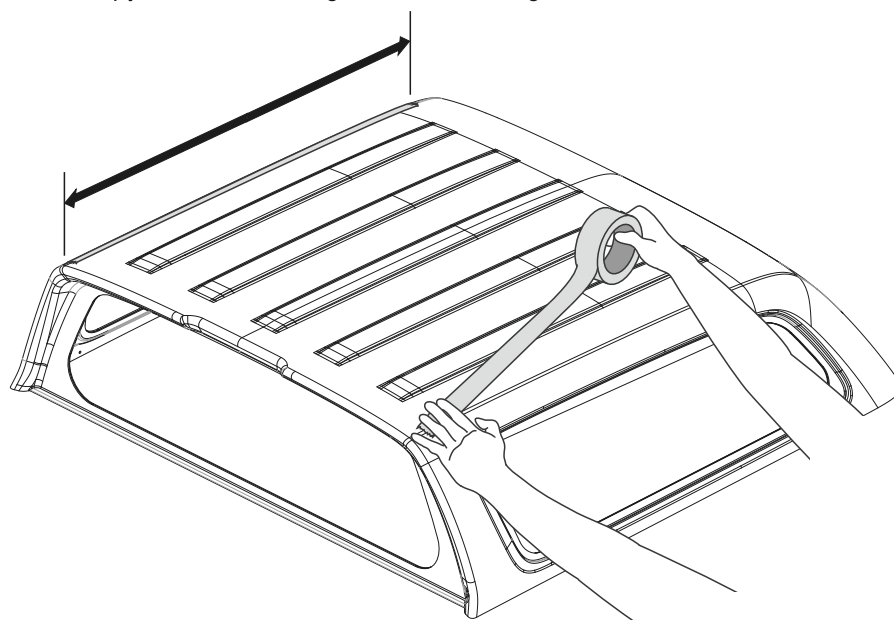

2

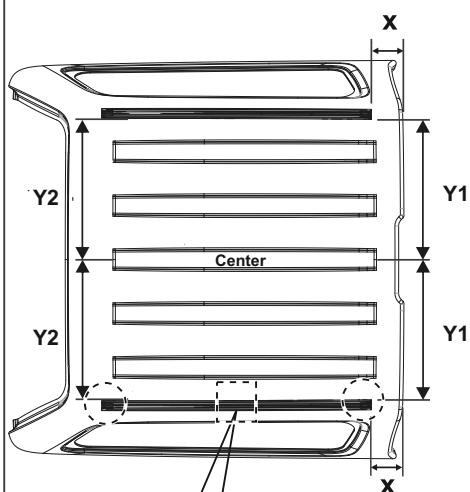

Vehicle Model	Canopy	X	Y1	Y2
Ford Ranger Gen 2022	Stylish	276	695	595
	Stylish Plus	210	573	577
	Innover	182	527	527
Toyota Hilux Revo Gen 2015	Stylish	262	574	584
	Innover	200	604	600
Volkswagen Amarok Gen 2023 (UK)	Stylish	275	540	540
	Innover	224	546	546
Nissan Navara Gen 2021 (Minor Change)	Stylish	258	555	555
Mitsubishi Triton Gen 2019	Innover	160	561	554
Isuzu RG 01 Gen 2019 Isuzu RG 14 Gen 2022 Mazda RG 17 Gen 2023	Stylish	276	563	556
Isuzu RG 01 Gen 2019 Isuzu RG 14 Gen 2022 Mazda RG 17 Gen 2024	Innover	194	567	555
Mitsubishi Triton Gen 2023	Innover	220	572	566
Chevrolet Colorado 2017 Isuzu RT Gen 2015	Stylish	224	564	579
<b>Drilling 5 positions :</b> Toyota Hilux Revo Gen 2015 Stylish* Nissan Navara Gen 2021 (EU) Stylish*				

Note : Detail for drilling 5 positions.

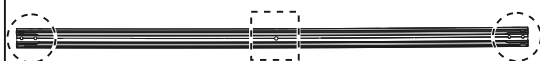

3

Dimension refer the Table

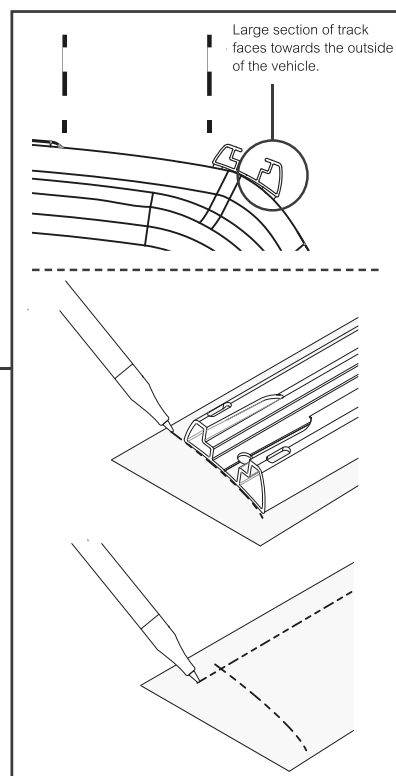
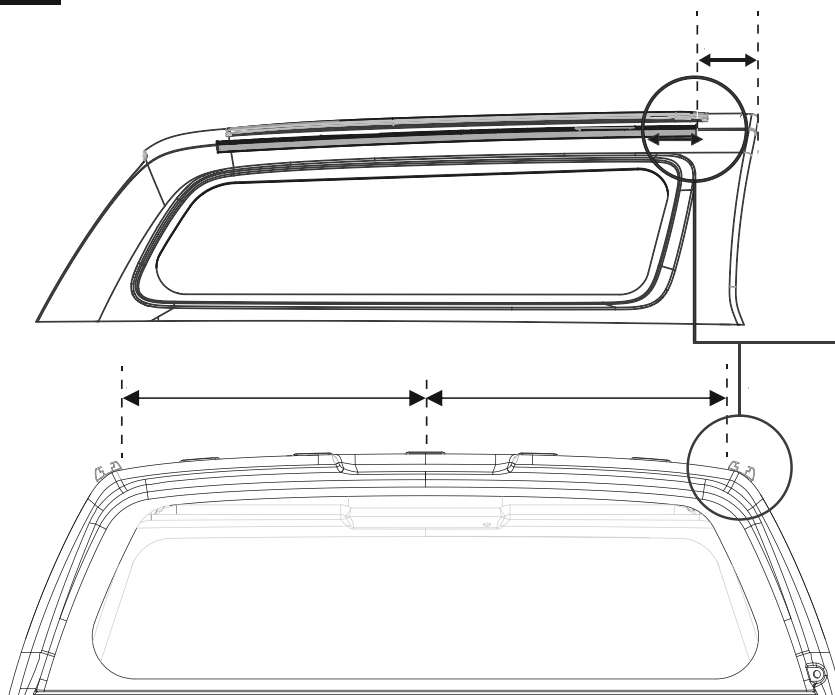

4

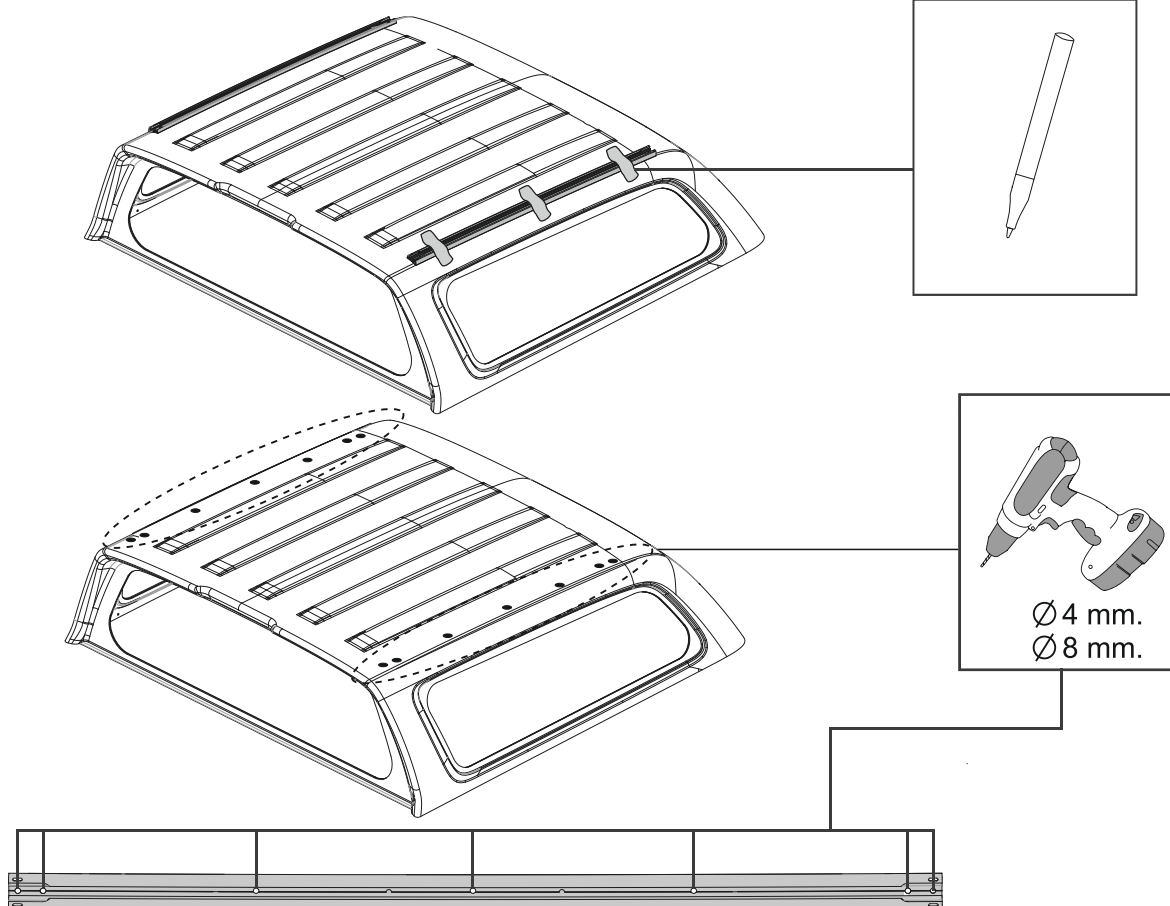

5

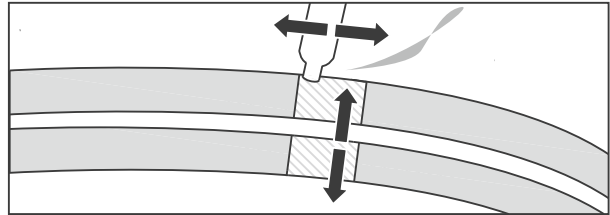
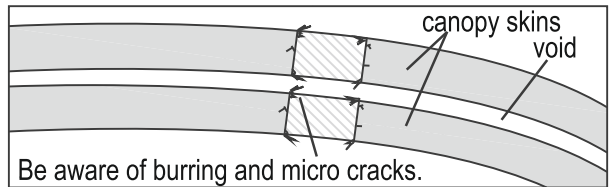
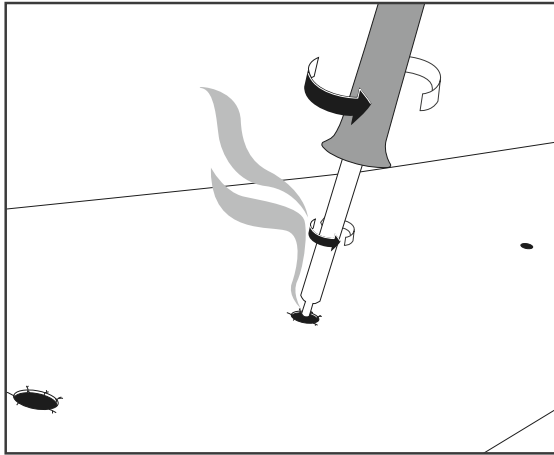

6

Remove the backing tape to stick with the roof track mount

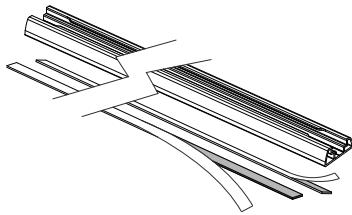

7

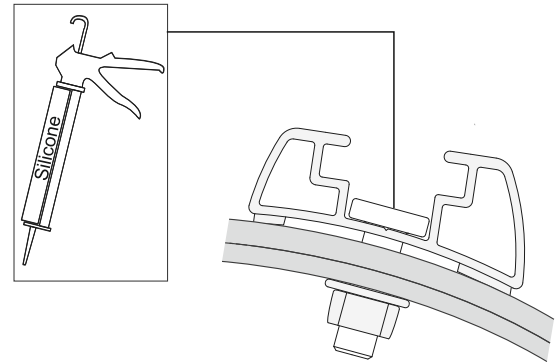

8

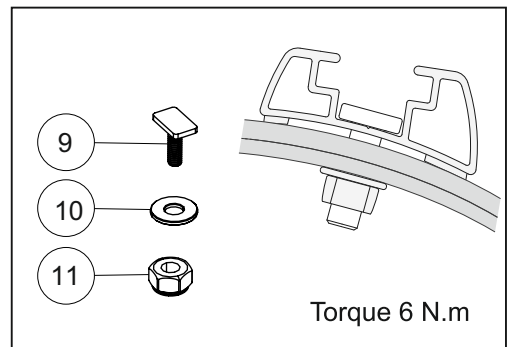
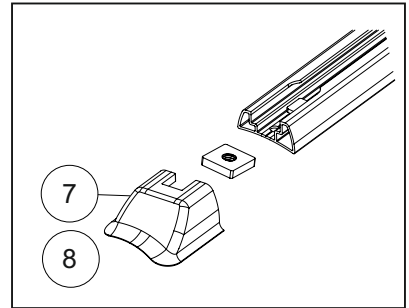
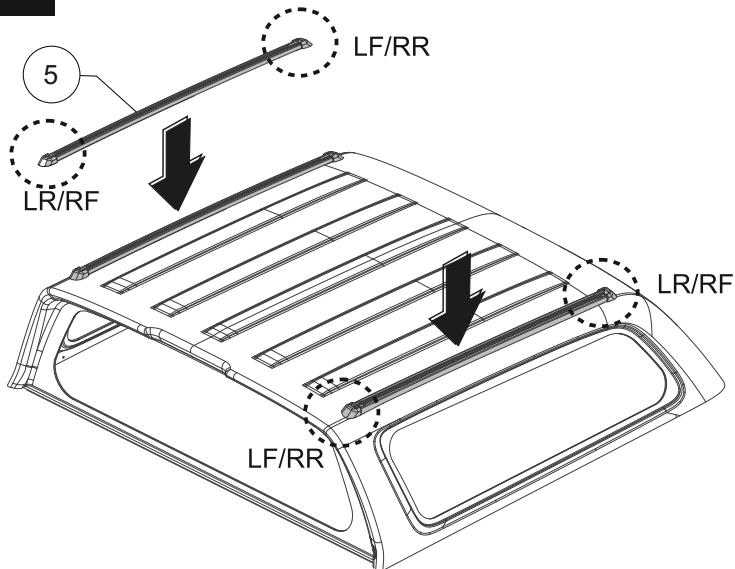

**Note : Repeat steps 1-8 opposing side**

## Assembly :

9

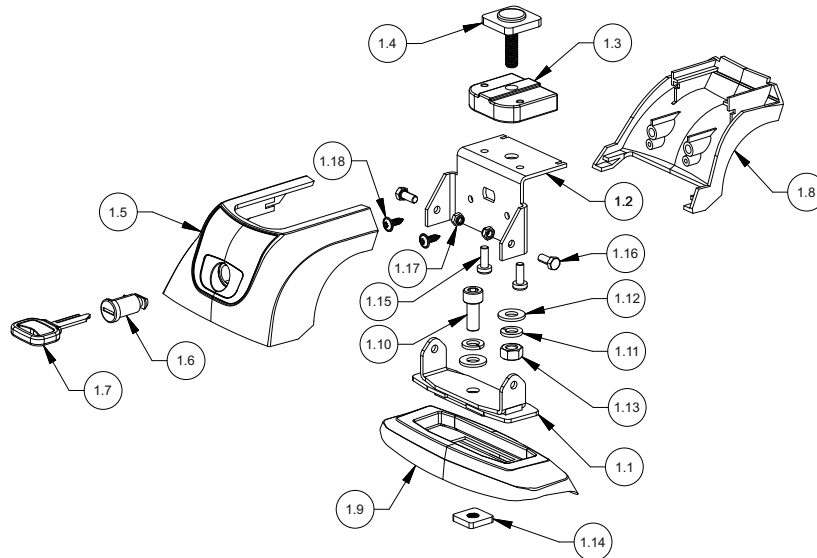

Q'TY	ITEM	PART NAME
4	1.1	FOOT BRACKET
4	1.2	TOP BRACKET
4	1.3	HOLDER BASE
4	1.4	T-BOLT 30x30 M8x1.25 L30
4	1.5	FRONT COVER
4	1.6	KEY SOCKET
2	1.7	KEY
4	1.8	BACK COVER
4	1.9	FOOT BRACKET RUBBER COVER
4	1.10	HEX SOCKET SCREW M8x1.25 L20
8	1.11	SPRING WASHER M8
8	1.12	PLAIN WASHER M8
4	1.13	HEX NUT M8x1.25
4	1.14	SQUARE NUT 20x20 M8x1.25
8	1.15	TORX SOCKET PAN HEAD SCREW M5x0.8 L14
8	1.16	HEX HEAD SCREW M5x0.8 L12
8	1.17	NYLON LOCK NUT M5x0.8
8	1.18	PHILLIPS PAN HEAD SELF TAPPING SCREW #8 L1/2

10

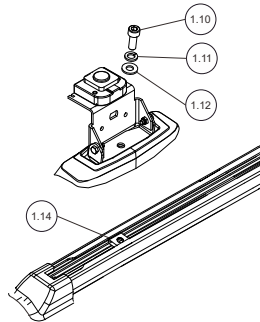

11

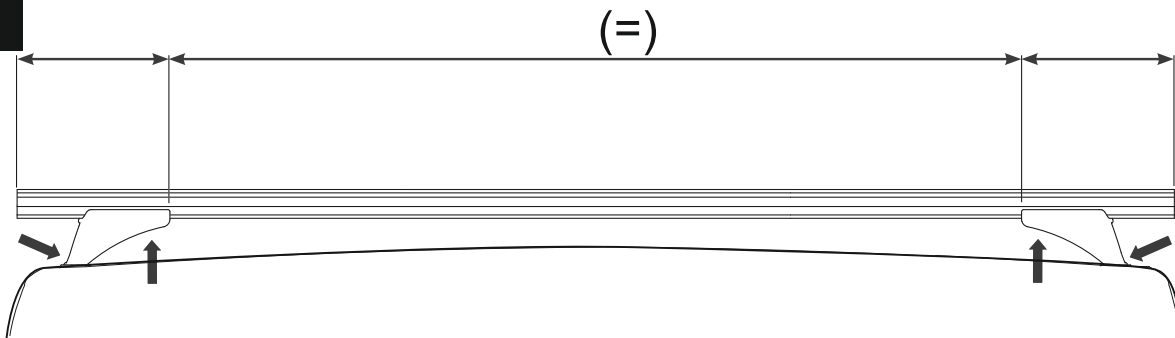

12

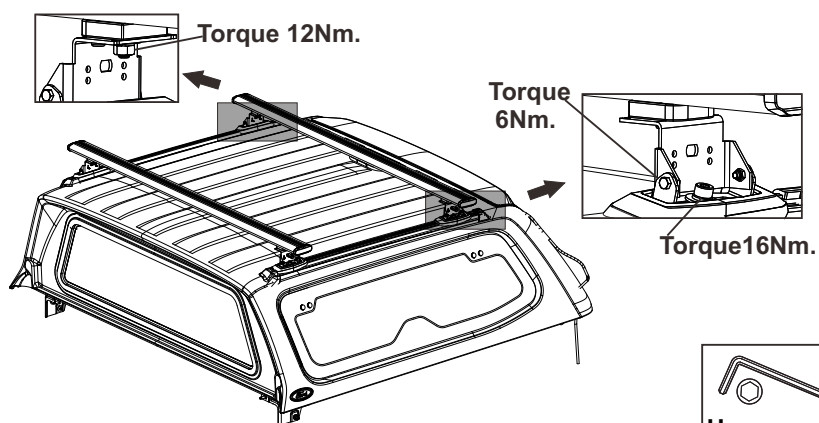

13

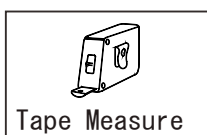

Rubber Strip Cutting Position

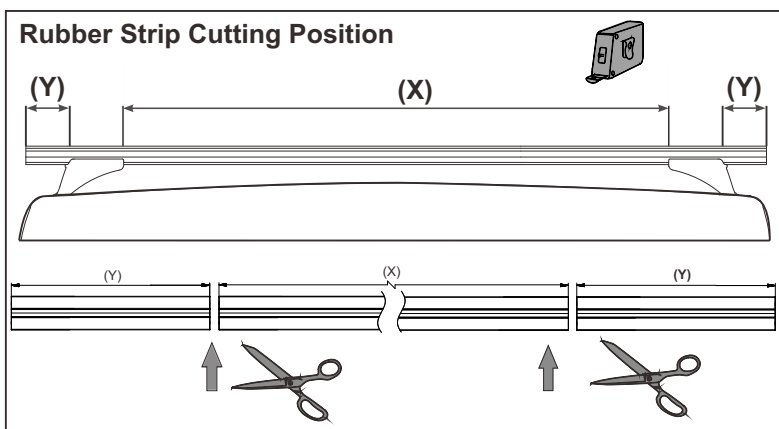

Rubber Strip Upper Cross Bar

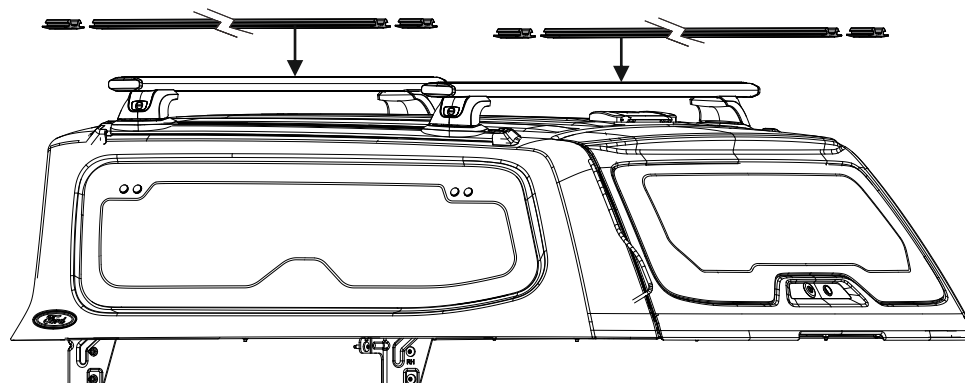

14



Figure 17

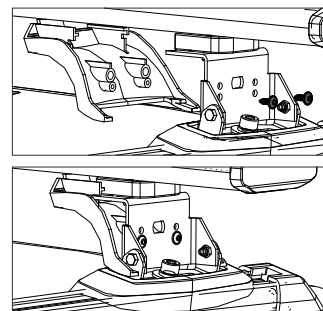
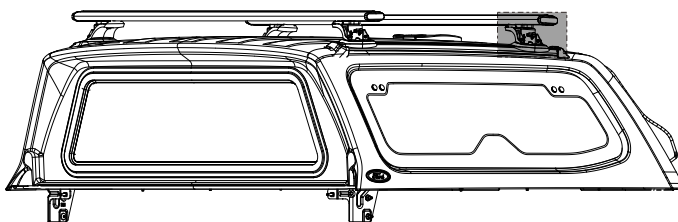

15

